

SALA DEL CONSIGLIO
H=8.00

Sup. mq	Sup./30 mq	Sup. Aeraaz. mq
126.7	4.22	9.95 > 1/30

CAPPELLINA
H=4.40

BAGNO

Aula prova orale

SALONE DEI RITRATTI - MUSEO
Hmax=10.40
Sup. 254.8 mq

Commissione

Ingresso

Controllo temperatura e greenpass

Identificazione

Uscita

Uscita

Uscita

Uscita

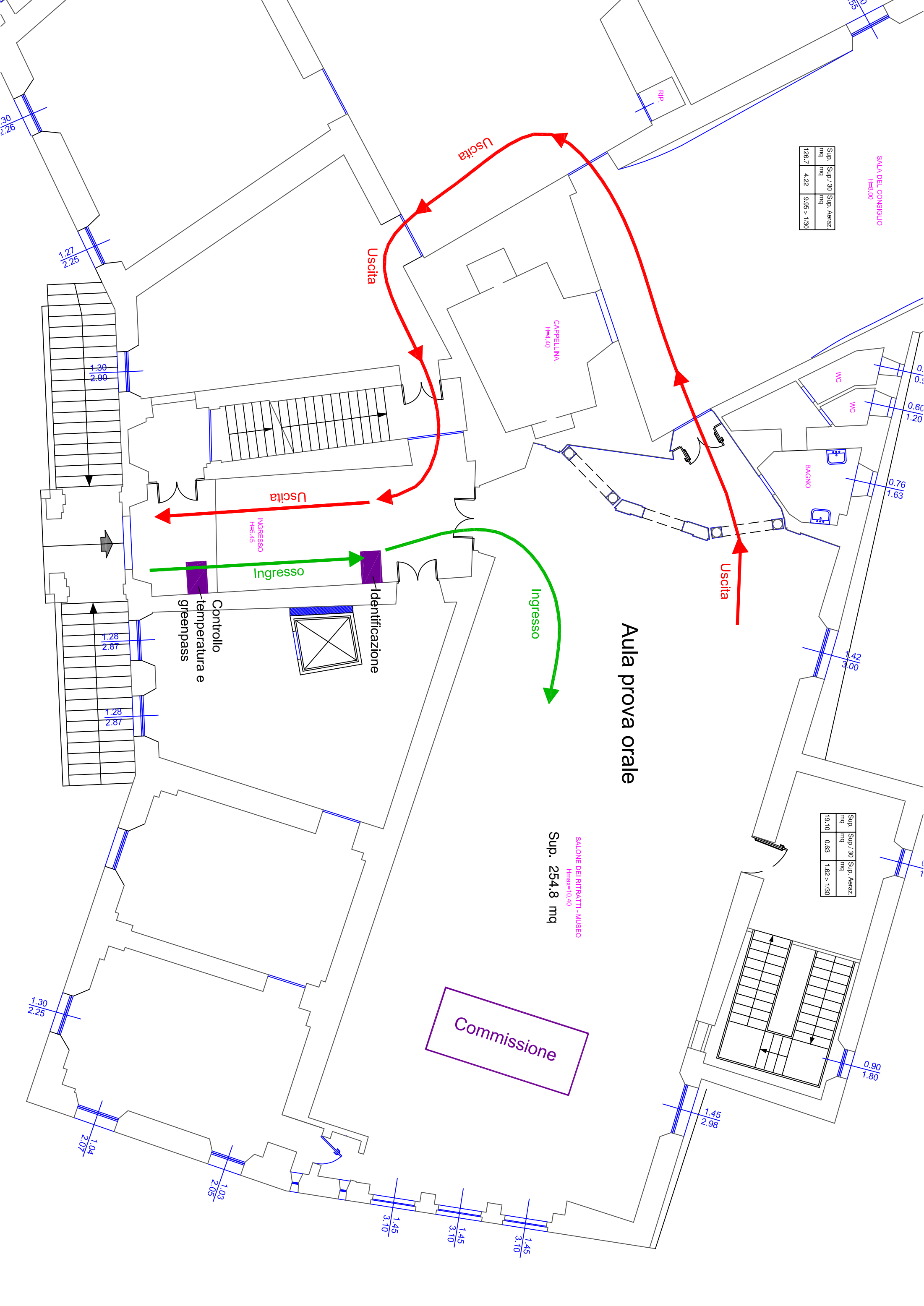

Sup. mq	Sup./30 mq	Sup. Aeraaz. mq
19.10	0.83	1.62 > 1/30

0.90
1.80

1.45
2.98

1.45
3.10

1.45
3.10

1.45
3.10

1.03
2.05

1.04
2.07

1.30
2.25

1.28
2.87

1.28
2.87

1.30
2.90

1.27
2.25

0.92
1.84

0.70
1.40

0.60
1.20

0.76
1.52

1.42
2.84

0.90
1.80

WC

WC

R.P.